



**Z-555**  
**8" [203mm] HEAVY-DUTY FLOOR DRAIN**  
**WITH DEEP ANTI-TILT GRATE**

SPECIFICATION SHEET

TAG \_\_\_\_\_



Dimensional Data (inches and [mm]) are Subject to Manufacturing Tolerances and Change Without Notice

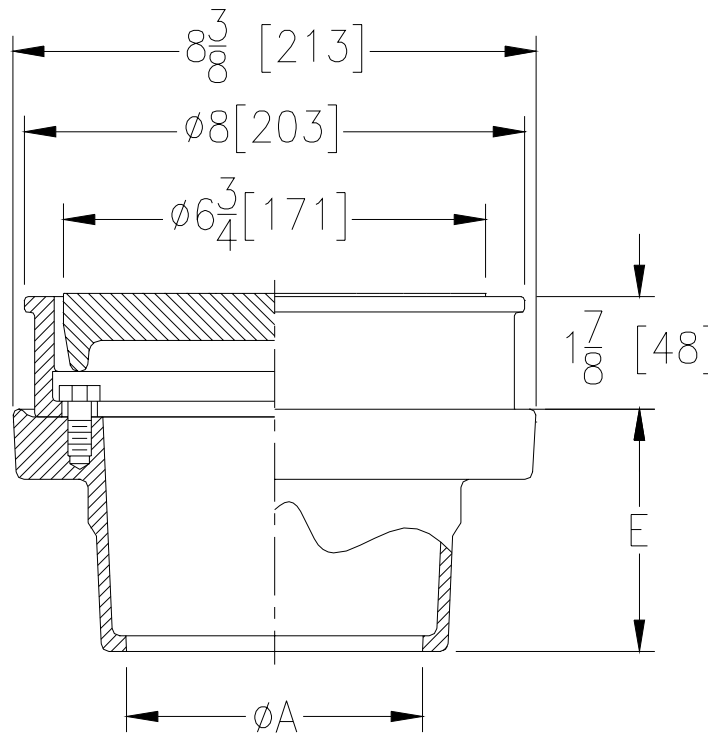

A Pipe Size Inches / [mm]	Approx. Wt. Lbs. / [kg]	Grate Open Area Sq. In. / [sq cm]
2-3-4-6 [51-76-102-152]	17 [8]	11 [71]

**ENGINEERING SPECIFICATION:** ZURN Z-555 8" [203mm] diameter heavy-duty floor drain, Dura-Coated cast iron bottom outlet body, seepage pan and combination membrane flashing clamp and frame for heavy-duty anti-tilt cast iron grate.

**OPTIONS** (Check/specify appropriate options)

**PIPE SIZE**

- 2,3,4 [50,75,100]
- 2,3,4 [50,75,100]
- 2,3,4,6 [50,75,100,152]
- 2,3,4 [50,75,100]
- 2,3,4 [50,75,100]

(Specify size/type) **OUTLET**

- \_\_\_\_\_ IC Inside Caulk
- \_\_\_\_\_ IG Inside Gasket
- \_\_\_\_\_ IP Threaded
- \_\_\_\_\_ NH No-Hub
- \_\_\_\_\_ NL Neo-Loc

**E BODY HT. DIM.**

- 3 7/8 [98]
- 3 7/8 [98]
- 2 5/8 [67]
- 3 7/8 [98]
- 4 5/8 [117]

**PREFIXES**

- \_\_\_\_\_ Z- D.C.C.I. Body with Grate\*
- \_\_\_\_\_ ZN- D.C.C.I. Body with Polished Nickel Bronze Top\*

\*Add 3/16" [5mm] to Min./Max. Dimension

**SUFFIXES**

- \_\_\_\_\_ -AR Acid-Resisting Epoxy Coated Cast Iron
- \_\_\_\_\_ -F0 3-1/2" x 9" [89 x 229] Funnel
- \_\_\_\_\_ -FS Floating Slab
- \_\_\_\_\_ -G Galvanized
- \_\_\_\_\_ -P 1/2" [13mm] Trap Primer Connection
- \_\_\_\_\_ -VP Vandal-Proof Secured Top
- \_\_\_\_\_ -X Squeezin Backwater Valve
- \_\_\_\_\_ -Y Sediment Bucket
- \_\_\_\_\_ -6NH 6" [152mm] No-Hub Outlet (IP w/ Z-1040)
- \_\_\_\_\_ -90 90° Threaded Side Outlet Body (IP or NH only)

<b>REV.</b>	<b>DATE: 11/15/99</b>	<b>C.N. NO. 83376</b>
<b>DWG. NO. 63664</b>	<b>PRODUCT NO. Z-555</b>	

\*REGULARLY FURNISHED UNLESS OTHERWISE SPECIFIED