



Z1446

CLEANOUT W/ ROUND WALL ACCESS COVER

SPECIFICATION SHEET

TAG _____

Dimensional Data (inches and [mm]) are Subject to Manufacturing Tolerances and Change Without Notice

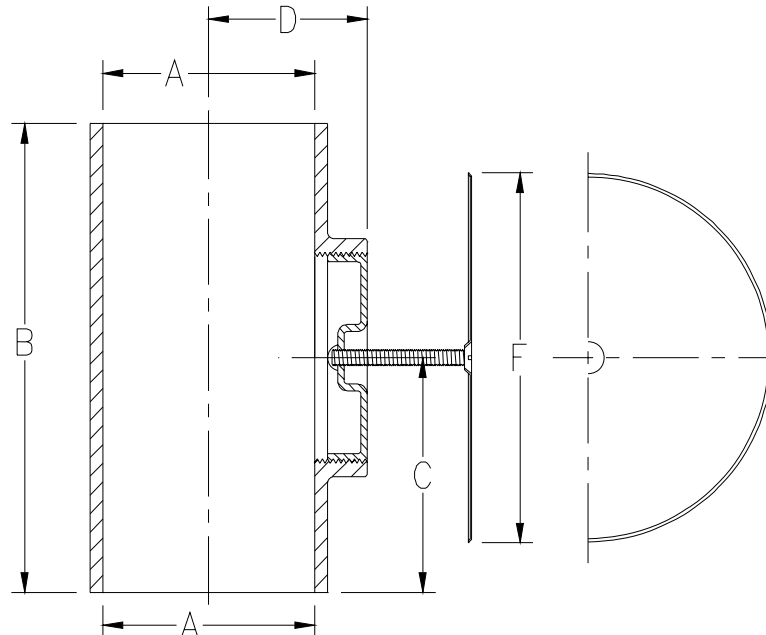

Dimensions In Inches									Approx. Wt. Lbs. [kg]
A- Pipe Size	NH				HB X SP				
	B	C	D	F	B	C	D	F	
2 [51]	6-3/8 [162]	3-3/16 [81]	1-3/4 [44]	5 [127]	10 [254]	4-1/2 [114]	2-3/4 [70]	5 [127]	9 [4]
3 [76]	7-3/4 [197]	3-7/8 [98]	2-1/2 [64]	5 [127]	12 [305]	5-3/4 [146]	3 [76]	5 [127]	16 [7]
4 [102]	8-7/8 [225]	4-7/16 [113]	3 [76]	7 [178]	12 [305]	5-3/4 [146]	3-1/2 [89]	7 [178]	18 [8]
5 [127]	—	—	—	—	13 [330]	6-1/4 [159]	4 [102]	7 [178]	24 [11]
6 [152]	12-1/2 [318]	6-1/4 [159]	4-5/16 [110]	9 [229]	14 [356]	6-3/4 [171]	4-1/2 [114]	9 [229]	38 [17]
8 [203]	—	—	—	—	17 [432]	8-1/4 [210]	5-1/2 [140]	11 [279]	53 [24]

ENGINEERING SPECIFICATION: ZURN Z1446

Cleanout Tee, Dura-Coated cast iron body, gas and watertight ABS tapered thread plug, and round, smooth stainless steel wall access cover with securing screw.

OPTIONS (Check/specify appropriate options)

PIPE SIZE

2 thru 4-6 [51 thru 102-152]
2 thru 6-8 [51 thru 152-203]

(Specify size/type) **OUTLET**

_____ NH No-Hub
_____ HB X SP Hub x Spigot

PREFIXES

_____ Z D.C.C.I. with Polished Stainless Steel Cover*
_____ ZB D.C.C.I. with Polished Bronze Cover

SUFFIXES

_____ -A Raised Head Plug
_____ -BP Bronze Plug
_____ -G Galvanized Cast Iron
_____ -SL Screws Longer Than 3-1/2 [89]
_____ -VP Vandal-Proof Screw

*REGULARLY FURNISHED UNLESS OTHERWISE SPECIFIED

REV. D	DATE: 11/04/10	C.N. NO. 120251
DWG. NO. 58767	PRODUCT NO. Z1446	